



CLERK'S OFFICE

APPROVED

Date: 6-11-02

Submitted by: Chairman of the Assembly at the
Request of the Mayor
Prepared by: Anchorage Water & Wastewater
Utility
For reading: May 21, 2002

ANCHORAGE, ALASKA
AR NO. 2002-166

**A RESOLUTION APPROVING THE STRAWBERRY ROAD WATER MAIN
EXTENSION AND PROVIDING FOR ASSESSMENT OF BENEFITED
PROPERTIES AT TIME OF SERVICE CONNECTION**

WHEREAS, Alaska State Statute 42.05.385 and AMC 19.90 mandate that when a water line extension will create, or has the potential of creating, any charge or assessment against the adjacent property, the water line extension may not be constructed unless the legislative body of each municipality through which the extension passes has approved the extension.

WHEREAS, the Anchorage Water and Wastewater Utility (AWWU) plans to construct water mains in the Strawberry Road right-of-way between Jewel Lake Road and Shady Birch Street.

WHEREAS, the extension of the water line will specially benefit and provide water service to ten (10) properties and in doing so, will create potential assessments against them.

NOW THEREFORE, THE ANCHORAGE ASSEMBLY RESOLVES:

Section 1. It is in the best interest of the community that said water main improvement proceed.

Section 2. AWWU shall keep an accurate account of all costs of the water main improvements.

Section 3. After the water main improvements have been completed and the costs of the water line approved, the Mayor shall cause the computation of all applicable assessment charges.

1 **Section 4.** At such time as the properties cited on the attached assessment
2 roll connects to the water main, the respective pro-rata assessment for the water
3 line shall be levied in accordance with Municipal Codes and the AWWU Water Utility
4 Tariff in effect at the time.

5
6 **Section 5.** A Special Assessment Collection Charge, as authorized in Rules
7 Section 13.4 and 15.1 of the Water Utility Tariff, in effect at the time the assessment
8 is levied, will be charged to those properties identified in this resolution.

9
10 **Section 6.** This resolution shall take effect immediately upon passage and
11 approval by the Anchorage Municipal Assembly.

12
13 **PASSED AND APPROVED** by the Anchorage Municipal Assembly this
14 17th day of June, 2002.

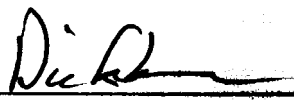
15
16
17
18
19
20
21
22
23
24
25
26

Chairman

ATTEST:

Municipal Clerk



STRAWBERRY ROAD JEWEL LAKE TO SHADY BIRCH
Capital Improvement Project - Water
Estimated Assessment Roll
AMS 1005

	Tax Code	Legal Description	Total Area	Asbl Area	Rate	Principal
1	012-242-13	Earles LT 1	13,500	13,572	1.02802	\$13,952.35
2	012-153-46	Hansen Sand Lake LT 16A	18,997	17,666	1.02802	\$18,161.08
3	012-153-21	Hansen Sand Lake LT 17	87,100	39,000	1.02802	\$40,092.95
4	012-153-83	Hansen Sand Lake LT 19A	159,920	74,308	1.02802	\$76,390.43
5	012-245-24	McHenry TR A	43,768	24,738	1.02802	\$25,431.26
6	012-242-38	Osmond Olsen LT 1A	16,662	16,662	1.02802	\$17,128.94
7	012-242-41	Osmond Olsen LT 1B	16,662	16,662	1.02802	\$17,128.94
8	012-242-56	Strawberry Patch BLK 1 LT 1	23,514	14,982	1.02802	\$15,401.86
9	012-242-04	T12N R4W SEC 11 E2NW4NE4NW4NW4	49,500	24,750	1.02802	\$25,443.60
10	012-242-05	T12N R4W SEC 11 W2NW4NE4NW4NW4	49,500	24,750	1.02802	\$25,443.60
TOTAL:						\$274,575.01

AR 2002-166 / AM 473-2002

RETURN TO:
Anchorage Water & Wastewater Utility
Private Development
3000 Arctic Boulevard
Anchorage, Alaska 99503-3898
(907) 564-2747



3 of 3

2002-066099-0



STRAWBERRY ROAD WATER LINE

AMS 1005

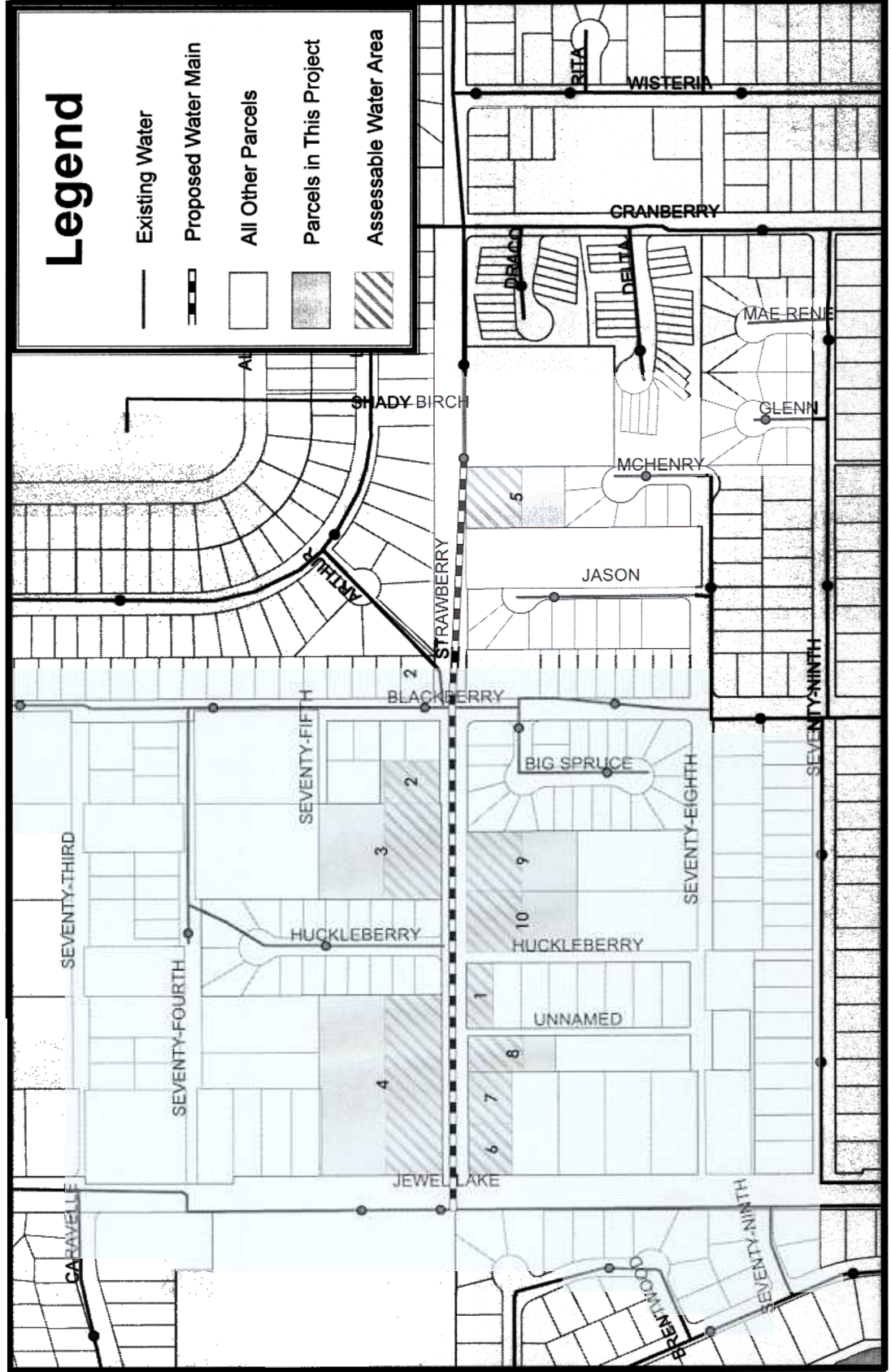

MUNICIPALITY OF ANCHORAGE

ASSEMBLY MEMORANDUM

AM No. 473-2002

Meeting Date May 21, 2002

1 **From:** Mayor

2
3 **Subject:** Approval of the Strawberry Road Water Main Extension and
4 Providing for Assessment of Benefiting Properties at Time of
5 Service Connection
6

7 AMC 19.90 and A.S. 42.05.385 require the Assembly's approval to construct a
8 water main extension where the extension will create any charges or assessments
9 against the adjacent properties. A public hearing is required prior to Assembly
10 action.
11

12 The Anchorage Water & Wastewater Utility (AWWU) plans to construct a 10-inch
13 water main in the Strawberry Road right-of-way between Jewel Lake Road and
14 Shady Birch Street. Construction of this main will add reliability and operating
15 flexibility to the public water system by connecting existing mains and "looping" the
16 neighborhood distribution system. The alignment and construction of this main
17 will also front, benefit and make water service available to ten (10) parcels. This
18 water main extension is planned in coordination with a municipal street
19 reconstruction project.
20

21 Initially, AWWU shall bear all costs of the construction of the proposed water main
22 extension. When these newly benefited and previously unassessed parcels
23 connect to the water main, AWWU shall recover a pro-rated share of the costs
24 through the Levy Upon Connection assessment procedures as authorized by the
25 current Municipal Codes and Utility Tariff.
26

27 The properties benefiting from the proposed construction are identified on the
28 assessment roll, which is made part of the resolution carried by this
29 memorandum. As these properties seek connection, the parcels' pro-rated share
30 of assessable water main costs will be presented to the Assembly for confirmation
31 of levy action.
32

33 The owners of benefited properties were notified of the estimated project cost and
34 the individual properties estimated cost allocation by mail on November 16, 2001.
35 The notification also invited the property owners to meet with AWWU staff if
36 desired.
37
38

1 THE ADMINISTRATION RECOMMENDS THE ASSEMBLY APPROVE THE
2 EXTENSION OF THE STRAWBERRY ROAD WATER MAIN.
3

4 Concurrence:

Recommended by:

5
6 
7
8 Harry Kieling
9 Municipal Manager

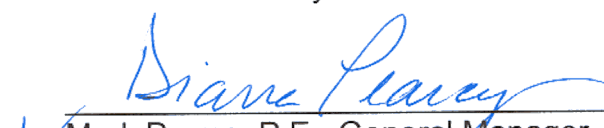
10
11 
12 Mark Premo, P.E., General Manager
13 Anchorage Water & Wastewater Utility
14

15 Respectfully submitted

16 
George P. Wuerch
Mayor

Municipality of Anchorage
MUNICIPAL CLERK'S OFFICE
Agenda Document Control Sheet

(SEE REVERSE SIDE FOR FURTHER INFORMATION)

AK 2002-

1	SUBJECT OF AGENDA DOCUMENT A resolution approving the Strawberry Road Water Main extension and providing for assessment of benefited properties at time of service connection.	DATE PREPARED April 24, 2002
		Indicate Documents Attached AO <input type="checkbox"/> AR <input checked="" type="checkbox"/> AM <input checked="" type="checkbox"/> AIM <input type="checkbox"/>
2	DEPARTMENT NAME AWWU	DIRECTOR'S NAME MARK PREMO, P.E.
3	THE PERSON THE DOCUMENT WAS ACTUALLY PREPARED BY Robert J Stachura <i>Robert J Stachura</i>	HIS/HER PHONE NUMBER 564-2712
4	COORDINATED WITH AND REVIEWED BY	INITIALS
5	Mayor	
	Heritage Land Bank	
	Merrill Field Airport	
	Municipal Light & Power	
	Port of Anchorage	
	Solid Waste Services	
2	Water & Wastewater Utility	<i>TS</i>
4	Municipal Manager	<i>m</i>
	Cultural & Recreational Services	
	Employee Relations	
	Finance, Chief Fiscal Officer	
	Fire	
	Health & Human Services	
	Office of Management and Budget	
	Management Information Services	
	Police	
	Planning, Development & Public Works	
	Development Services	
	Facility Management	
	Planning	
	Project Management & Engineering	
	Street Maintenance	
	Traffic	
	Public Transportation Department	
	Purchasing	
3	Municipal Attorney <i>1186</i>	<i>WOF</i>
	Municipal Clerk	<i>5/13/02</i>
1	Other AWWU Special Assessments	<i>cut</i>
	Special Instructions/Comments	
	<i>Introduction</i>	
6	ASSEMBLY HEARING DATE REQUESTED MAY 21 2002	PUBLIC HEARING DATE REQUESTED 6/11/02

2002 MAY 15 AM 8:09
 CLERK'S OFFICE
 M.O.A.